

**Herefordshire**  
**Application to vary a premises licence**  
**Licensing Act 2003**

For help contact  
[licensing@herefordshire.gov.uk](mailto:licensing@herefordshire.gov.uk)  
 Telephone: 01432 261761

\* required information

### Section 1 of 18

You can save the form at any time and resume it later. You do not need to be logged in when you resume.

- System reference  This is the unique reference for this application generated by the system.
- Your reference  You can put what you want here to help you track applications if you make lots of them. It is passed to the authority.
- Are you an agent acting on behalf of the applicant? Put "no" if you are applying on your own behalf or on behalf of a business you own or work for.
- Yes  No

### Applicant Details

- \* First name
- \* Family name
- \* E-mail
- Main telephone number  Include country code.
- Other telephone number
- Indicate here if the applicant would prefer not to be contacted by telephone

Is the applicant:

- Applying as a business or organisation, including as a sole trader
- Applying as an individual
- A sole trader is a business owned by one person without any special legal structure. Applying as an individual means the applicant is applying so the applicant can be employed, or for some other personal reason, such as following a hobby.

### Applicant Business

- Is the applicant's business registered in the UK with Companies House?  Yes  No
- Registration number
- Business name  If the applicant's business is registered, use its registered name.
- VAT number   Put "none" if the applicant is not registered for VAT.
- Legal status

*Continued from previous page...*

Applicant's position in the business

Home country

The country where the applicant's headquarters are.

**Registered Address**

Address registered with Companies House.

Building number or name

Street

District

City or town

County or administrative area

Postcode

Country

**Agent Details**

\* First name

\* Family name

\* E-mail

Main telephone number

Include country code.

Other telephone number

Indicate here if you would prefer not to be contacted by telephone

Are you:

- An agent that is a business or organisation, including a sole trader
- A private individual acting as an agent

A sole trader is a business owned by one person without any special legal structure.

**Agent Business**

Is your business registered in the UK with Companies House?  Yes  No

Note: completing the Applicant Business section is optional in this form.

Registration number

Business name

If your business is registered, use its registered name.

VAT number

Put "none" if you are not registered for VAT.

Legal status

*Continued from previous page...*

Your position in the business

Home country

The country where the headquarters of your business is located.

**Agent Registered Address**

Address registered with Companies House.

Building number or name

Street

District

City or town

County or administrative area

Postcode

Country

**Section 2 of 18**

**APPLICATION DETAILS**

**This application cannot be used to vary the licence so as to extend the period for which the licence has effect or to vary substantially the premises to which it relates. If you wish to make that type of change to the premises licence, you should make a new premises licence application under section 17 of the Licensing Act 2003.**

I/we, as named in section 1, being the premises licence holder, apply to vary a premises licence under section 34 of the Licensing Act 2003 for the premises described in section 2 below.

\* Premises Licence Number

Are you able to provide a postal address, OS map reference or description of the premises?

- Address     OS map reference     Description

**Postal Address Of Premises**

Building number or name

Street

District

City or town

County or administrative area

Postcode

Country

**Premises Contact Details**

Telephone number

Continued from previous page...

Non-domestic rateable  
value of premises (£)

16,500

### Section 3 of 18

#### VARIATION

Do you want the proposed  
variation to have effect as  
soon as possible?

Yes  No

Do you want the proposed variation to have effect in relation to the  
introduction of the late night levy?

Yes  No

You do not have to pay a fee if the only  
purpose of the variation for which you are  
applying is to avoid becoming liable to the  
late night levy.

If your proposed variation  
would mean that 5,000 or  
more people are expected to  
attend the premises at any  
one time, state the number  
expected to attend

#### Describe Briefly The Nature Of The Proposed Variation

Describe the premises. For example the type of premises, its general situation and layout and any other information which could be relevant to the licensing objectives. Where your application includes off-supplies of alcohol and you intend to provide a place for consumption of these off-supplies, you must include a description of where the place will be and its proximity to the premises.

##### Current Position

The premises are currently licensed under Premises Licence no. PR00066 and the current approved Premises Licence drawing dates back to May 2005 and reflects the licensed area internally at ground floor and first floor and externally at ground floor.

This layout was approved to the Premises Licence following the conversion to the Licensing Act 2003 regime.

##### Purpose of Variation

This application seeks approval for alterations to the approved layout of the premises both internally and externally and to regularise the position in respect of the external beer garden and garage area at the premises.

A copy of the plan showing the proposed layout being drawing no. 12541/15507/DF is attached to this application.

The application would seek to incorporate formally the external beer garden, covered walkway and garage serverly area within the licensed area as reflected on the plan deposited with the application.

##### Internal Alterations

Briefly the internal alterations comprise the inclusion of the area prior to the covered walkway out to the external area to be included in the overall licensed footprint for the site to properly reflect the premises usage.

##### External Alterations

*Continued from previous page...*

Briefly the alterations comprise externally as follows:-

- The covered walkway external beer garden and garage servery to be incorporated into the licensed area, to be managed by the relevant conditions already in place on Premises Licence no. PR00066.
- The "garage servery" to be incorporated into the licensed area externally.
- The principal inclusion of the "garage servery" area is to allow the venue to be able to offer a servery to assist with the safe and controlled facilitation of customers at the premises. The external area would still be subject to the condition on the Premises Licence namely "the outside area shall not be used for the consumption of alcohol or licensable activities after 11.30pm".

The external area which it is proposed would include the garage servery has traditionally been used as a consumption area and this will not change aside from the licensing of the garage servery and the entirety of the external layout itself. The inclusion of this serves to assist the premises in the provision of licensable activities at the premises. The works themselves are intended to improve the premises and it is not anticipated that the licensing objectives will be adversely affected by this variation and the operating statement has been completed on that basis.

In that there is no change to the hours proposed by the application or conditions, boxes A – H, late night refreshment and sale by retail of alcohol have not been completed.

#### Section 4 of 18

##### PROVISION OF PLAYS

[See guidance on regulated entertainment](#)

Will the schedule to provide plays be subject to change if this application to vary is successful?

- Yes  No

#### Section 5 of 18

##### PROVISION OF FILMS

[See guidance on regulated entertainment](#)

Will the schedule to provide films be subject to change if this application to vary is successful?

- Yes  No

#### Section 6 of 18

##### PROVISION OF INDOOR SPORTING EVENTS

[See guidance on regulated entertainment](#)

Will the schedule to provide indoor sporting events be subject to change if this application to vary is successful?

- Yes  No

#### Section 7 of 18

##### PROVISION OF BOXING OR WRESTLING ENTERTAINMENTS

[See guidance on regulated entertainment](#)

Will the schedule to provide boxing or wrestling entertainments be subject to change if this application to vary is successful?

- Yes  No

*Continued from previous page...*

**Section 8 of 18**

**PROVISION OF LIVE MUSIC**

[See guidance on regulated entertainment](#)

Will the schedule to provide live music be subject to change if this application to vary is successful?

- Yes  No

**Section 9 of 18**

**PROVISION OF RECORDED MUSIC**

[See guidance on regulated entertainment](#)

Will the schedule to provide recorded music be subject to change if this application to vary is successful?

- Yes  No

**Section 10 of 18**

**PROVISION OF PERFORMANCES OF DANCE**

[See guidance on regulated entertainment](#)

Will the schedule to provide performances of dance be subject to change if this application to vary is successful?

- Yes  No

**Section 11 of 18**

**PROVISION OF ANYTHING OF A SIMILAR DESCRIPTION TO LIVE MUSIC, RECORDED MUSIC OR PERFORMANCES OF DANCE**

[See guidance on regulated entertainment](#)

Will the schedule to provide anything similar to live music, recorded music or performances of dance be subject to change if this application to vary is successful?

- Yes  No

**Section 12 of 18**

**PROVISION OF LATE NIGHT REFRESHMENT**

Will the schedule to provide late night refreshment be subject to change if this application to vary is successful?

- Yes  No

**Section 13 of 18**

**SUPPLY OF ALCOHOL**

Will the schedule to supply alcohol be subject to change if this application to vary is successful?

- Yes  No

**Section 14 of 18**

**ADULT ENTERTAINMENT**

*Continued from previous page...*

Highlight any adult entertainment or services, activities, or other entertainment or matters ancillary to the use of the premises that may give rise to concern in respect of children.

Provide information about anything intended to occur at the premises or ancillary to the use of the premises which may give rise to concern in respect of children, regardless of whether you intend children to have access to the premises, for example (but not exclusively) nudity or semi-nudity, films for restricted age groups etc gambling machines etc.

Not applicable

## Section 15 of 18

### HOURS PREMISES ARE OPEN TO THE PUBLIC

#### Standard Days And Timings

MONDAY

Start

End

Start

End

Provide timings in 24 hour clock (e.g., 16:00) and only give details for the days of the week when you intend the premises to be used for the activity.

TUESDAY

Start

End

Start

End

WEDNESDAY

Start

End

Start

End

THURSDAY

Start

End

Start

End

FRIDAY

Start

End

Start

End

SATURDAY

Start

End

Start

End

SUNDAY

Start

End

Start

End

State any seasonal variations.

For example (but not exclusively) where the activity will occur on additional days during the summer months.

*Continued from previous page...*

Non standard timings. Where you intend to use the premises to be open to the members and guests at different times from those listed above, list below.

For example (but not exclusively), where you wish the activity to go on longer on a particular day e.g. Christmas Eve.

Identify those conditions currently imposed on the licence which you believe could be removed as a consequence of the proposed variation you are seeking.

- I have enclosed the premises licence
- I have enclosed the relevant part of the premises licence

Reasons why I have failed to enclose the premises licence or relevant part of premises licence.

**Section 16 of 18**

**LICENSING OBJECTIVES**

Describe the steps you intend to take to promote the four licensing objectives:

a) General – all four licensing objectives (b,c,d,e)

List here steps you will take to promote all four licensing objectives together.

I have undertaken my own risk assessment to take the following proposed steps.

This application is principally made to incorporate and regularise the external areas within the licensed area at the premises. The current conditions as reflected on Premises Licence no. PR00066 are reasonable and proportionate to any variation to the Licence upon this application and no further risks have been identified which need to be addressed.

b) The prevention of crime and disorder

No further risks have been identified which need to be addressed

c) Public safety



*Continued from previous page...*

No further risks have been identified which need to be addressed

d) The prevention of public nuisance

No further risks have been identified which need to be addressed

e) The protection of children from harm

The restrictions set out in the Licensing Act 2003 will apply. No unusual or additional risks of harm to children have been identified.

**Section 17 of 18**

**NOTES ON REGULATED ENTERTAINMENT**

*Continued from previous page...*

In terms of specific **regulated entertainments** please note that:

- Plays: no licence is required for performances between 08:00 and 23.00 on any day, provided that the audience does not exceed 500.
- Films: no licence is required for 'not-for-profit' film exhibition held in community premises between 08.00 and 23.00 on any day provided that the audience does not exceed 500 and the organiser (a) gets consent to the screening from a person who is responsible for the premises; and (b) ensures that each such screening abides by age classification ratings.
- Indoor sporting events: no licence is required for performances between 08.00 and 23.00 on any day, provided that the audience does not exceed 1000.
- Boxing or Wrestling Entertainment: no licence is required for a contest, exhibition or display of Greco-Roman wrestling, or freestyle wrestling between 08.00 and 23.00 on any day, provided that the audience does not exceed 1000. Combined fighting sports – defined as a contest, exhibition or display which combines boxing or wrestling with one or more martial arts – are licensable as a boxing or wrestling entertainment rather than an indoor sporting event.
- Live music: no licence permission is required for:
  - o a performance of unamplified live music between 08.00 and 23.00 on any day, on any premises.
  - o a performance of amplified live music between 08.00 and 23.00 on any day on premises authorised to sell alcohol for consumption on those premises, provided that the audience does not exceed 500.
  - o a performance of amplified live music between 08.00 and 23.00 on any day, in a workplace that is not licensed to sell alcohol on those premises, provided that the audience does not exceed 500.
  - o a performance of amplified live music between 08.00 and 23.00 on any day, in a church hall, village hall, community hall, or other similar community premises, that is not licensed by a premises licence to sell alcohol, provided that (a) the audience does not exceed 500, and (b) the organiser gets consent for the performance from a person who is responsible for the premises.
  - o a performance of amplified live music between 08.00 and 23.00 on any day, at the non-residential premises of (i) a local authority, or (ii) a school, or (iii) a hospital, provided that (a) the audience does not exceed 500, and (b) the organiser gets consent for the performance on the relevant premises from: (i) the local authority concerned, or (ii) the school or (iii) the health care provider for the hospital.
- Recorded Music: no licence permission is required for:
  - o any playing of recorded music between 08.00 and 23.00 on any day on premises authorised to sell alcohol for consumption on those premises, provided that the audience does not exceed 500.
  - o any playing of recorded music between 08.00 and 23.00 on any day, in a church hall, village hall, community hall, or other similar community premises, that is not licensed by a premises licence to sell alcohol, provided that (a) the audience does not exceed 500, and (b) the organiser gets consent for the performance from a person who is responsible for the premises.
  - o any playing of recorded music between 08.00 and 23.00 on any day, at the non-residential premises of (i) a local authority, or (ii) a school, or (iii) a hospital, provided that (a) the audience does not exceed 500, and (b) the organiser gets consent for the performance on the relevant premises from: (i) the local authority concerned, or (ii) the school proprietor or (iii) the health care provider for the hospital.

*Continued from previous page...*

- Dance: no licence is required for performances between 08.00 and 23.00 on any day, provided that the audience does not exceed 500. However, a performance which amounts to adult entertainment remains licensable.
- Cross activity exemptions: no licence is required between 08.00 and 23.00 on any day, with no limit on audience size for:
  - o any entertainment taking place on the premises of the local authority where the entertainment is provided by or on behalf of the local authority;
  - o any entertainment taking place on the hospital premises of the health care provider where the entertainment is provided by or on behalf of the health care provider;
  - o any entertainment taking place on the premises of the school where the entertainment is provided by or on behalf of the school proprietor; and
  - o any entertainment (excluding films and a boxing or wrestling entertainment) taking place at a travelling circus, provided that (a) it takes place within a moveable structure that accommodates the audience, and (b) that the travelling circus has not been located on the same site for more than 28 consecutive days.

## Section 18 of 18

### PAYMENT DETAILS

This fee must be paid to the authority. If you complete the application online, you must pay it by debit or credit card.

Variation Fees are determined by the non domestic rateable value of the premises.

To find out a premises non domestic rateable value go to the Valuation Office Agency site at [http://www.voa.gov.uk/business\\_rates/index.htm](http://www.voa.gov.uk/business_rates/index.htm)

Band A - No RV to £4300	£100.00
Band B - £4301 to £33000	£190.00
Band C - £33001 to £87000	£315.00
Band D - £87001 to £125000	£450.00*
Band E - £125001 and over	£635.00*

\*If the premises rateable value is in Bands D or E and the premises is primarily used for the consumption of alcohol on the premises then you are required to pay a higher fee

Band D - £87001 to £125000	£900.00
Band E - £125001 and over	£1,905.00

If you own a large premise you are subject to additional fees based upon the number in attendance at any one time

Capacity 5000-9999	£1,000.00
Capacity 10000 -14999	£2,000.00
Capacity 15000-19999	£4,000.00
Capacity 20000-29999	£8,000.00
Capacity 30000-39999	£16,000.00
Capacity 40000-49999	£24,000.00
Capacity 50000-59999	£32,000.00
Capacity 60000-69999	£40,000.00
Capacity 70000-79999	£48,000.00
Capacity 80000-89999	£56,000.00
Capacity 90000 and over	£64,000.00

\* Fee amount (£)

### DECLARATION

I/we understand it is an offence, liable on conviction to a fine up to level 5 on the standard scale, under section 158 of the

*Continued from previous page...*

\* licensing act 2003, to make a false statement in or in connection with this application.

Ticking this box indicates you have read and understood the above declaration

This section should be completed by the applicant, unless you answered "Yes" to the question "Are you an agent acting on behalf of the applicant?"

\* Full name

\* Capacity

\* Date  /  /   
dd mm yyyy

Once you're finished you need to do the following:

1. Save this form to your computer by clicking file/save as...
2. Go back to <https://www.gov.uk/apply-for-a-licence/premises-licence/herefordshire/change-1> to upload this file and continue with your application.

Don't forget to make sure you have all your supporting documentation to hand.

**IT IS AN OFFENCE, UNDER SECTION 158 OF THE LICENSING ACT 2003, TO MAKE A FALSE STATEMENT IN OR IN CONNECTION WITH THIS APPLICATION. THOSE WHO MAKE A FALSE STATEMENT MAY BE LIABLE ON SUMMARY CONVICTION TO A FINE OF ANY AMOUNT.**

**OFFICE USE ONLY**

Applicant reference number

Fee paid

Payment provider reference

ELMS Payment Reference

Payment status

Payment authorisation code

Payment authorisation date

Date and time submitted

Approval deadline

Error message

Is Digitally signed

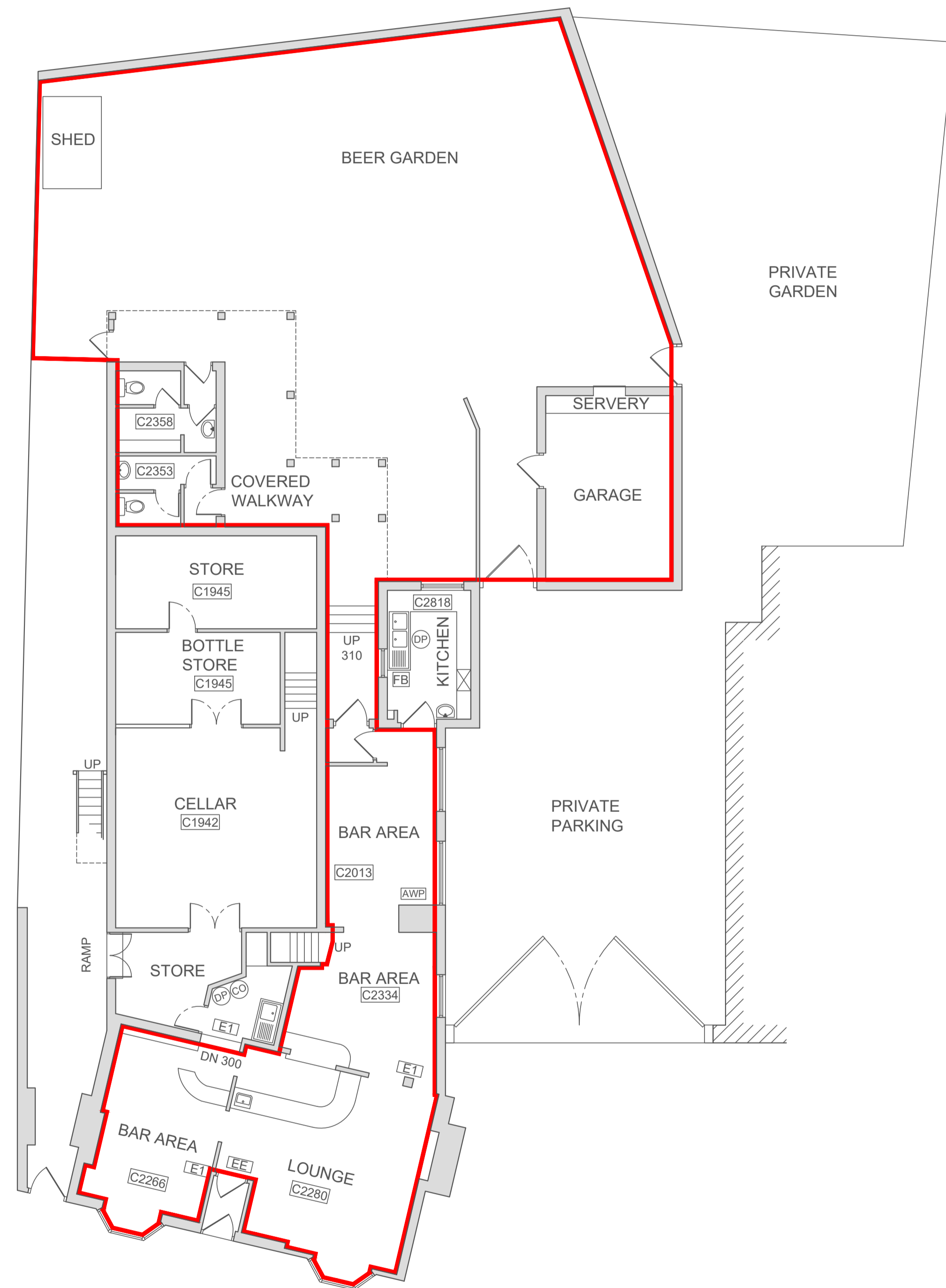

GROUND FLOOR PLAN



FIRST FLOOR PLAN

**NOTES:**  
 1/ Each layout on the drawing has detailed against it how the information was gathered and drawn:  
 Check Survey - Information has been drawn up from original paper drawings and then checked on site and modified accordingly.  
 Full Survey - Complete on site survey carried out

**KEY**

- [N1] General Fire Notice
- [N2] Staff Fire Notice
- [N3] 'Fire Door Keep Locked' sign
- [N4] 'Fire Exit Keep Clear' sign
- [N5] 'Fire Door Keep Locked' sign
- [FB] Fire Blanket
- [DP] Dry Powder Fire Extinguisher
- [CO] Carbon Dioxide Fire Extinguisher
- [FO] Foam Fire Extinguisher
- [WA] Water Fire Extinguisher
- [E1] Emergency Light Fitting
- [EE] Emergency Exit Sign
- [H] Heat Detector
- [S] Smoke Detector
- [C] Break Glass Call Point
- [L] Fire Alarm Sounder
- [FAP] Fire Alarm Panel
- [AWP] Amusement with Prizes
- [SWP] Skill with Prizes
- [ATM] Cash machines
- [PP] Pay Phone
- [J] Juke Box
- [C] Cigarette M/c

Revision	Date	By	Note
Revision F			
Revision E			
Revision D			
Revision C			
Revision B			
Revision A			

	<b>fishercad</b> Services Ltd 4-6 Poplar Court Union Street Bridgton Cannock Staffordshire WS11 3BY  Tele: 01543 504543 Fax: 01543 467117 Email: drawings@fishercad.co.uk
	Services WEB Site: fishercad.co.uk

**JOB TITLE**  
 THE BREWERY INN,  
 HEREFORD.

**DRAWING**  
 GROUND FLOOR PLAN  
 WITH BEER GRADEN  
 & FIRST FLOOR PLAN

SCALE	DATE	DRAWN
1:100	MAY '05	
PROJECT	DRAWING NO	PHC
UPC-LIC	12541/15507/DF	15507